

## VERY HIGH PRESSURE HOSE AND FITTINGS



## // HOSE AND FITTINGS

The ALFAGOMMA HP700 product range ensures maximum safety at extreme pressures.

Aramid braid strengthened with steel wire braid enables highest pressure resistance and keeps the thermoplastic hose as a lightweight.

Extremely small bend radius and abrasion resistant outer cover allows operating in smallest installation spaces as example for use in energy chains.

### // FLEXOR HP700

Thermoplastic constant pressure hose for very high pressure hydraulic applications



**Tube:** polyester.

**Reinforcement:** one or two braids of aramid fiber plus one braid of steel wire.

**Cover:** polyurethane - red - non pinpricked - black inkjet branding.

**Application:** rescue and safety equipment - high pressure systems and pumps - bolt tensioning tools - jacking and rerailing equipment.

**Features:** combined aramid steel braid construction for compact design - lightweight and flexible - small bend radius for use on hose reels and in tight environments - antiabrasion cover.

**Constant operation:** -40 °C +100 °C (-40 °F +212 °F); limited to +70 °C (+158 °F) for air and water based fluids.

**Description:** exceeds the former American Jacking Specifications IJ100 (1/4") - Very High Pressure hose suitable for petroleum or synthetic or water based hydraulic fluids in hydraulic systems - combined aramid steel braid ensures longevity, pressure performance and compact design.

**Vacuum rating:** 0,93 bar; 700 mm Hgl-13,5 psi; 27,5 inch Hgw.

Item Code	↻			↻		↻		↻		↻		↻	
	Dash	mm	inch	mm	inch	Mpa	psi	Mpa	psi	mm	inch	kg/m	lb/ft
SHTP-TR-00003	-4	6	1/4	12,7	0,5	70	10000	280	40000	35	1,38	0,18	12,1

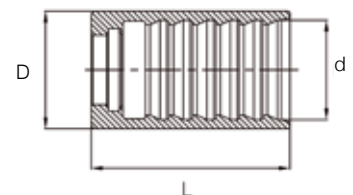

### // HP700 FERRULES

Item Code	↻			D mm	d mm	L mm	Material
	Dash	DN	inch				
SHFF-TR-00008	-4	6	1/4	20	15	38,4	Steel
SHFF-TR-00009	-4	6	1/4	20	15	38,4	AISI 316L

## // HP700 FITTINGS

### DKOS

Female with O-ring, heavy series,  
fitting mating with flare 24°  
DIN EN ISO 8434-1

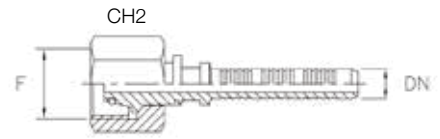

Item Code				F	RA mm	CH2 mm	Material
	Dash	DN	inch				
SHFI-TR-00022	-4	6	1/4	M16x1,5	8	19	Steel
SHFI-TR-00016	-4	6	1/4	M18x1,5	10	22	Steel

### DKR

Fitting with BSP union nut and O-ring,  
mating with 60° flare with pipe thread G



Item Code				F inch	CH2 mm	Material
	Dash	DN	inch			
SHFI-TR-00019	-4	6	1/4	1/4	8	Steel

### AGN

Fitting with NPTF thread (dry sealing)  
mating with NPTF threaded ports

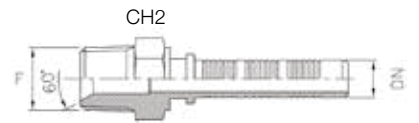

Item Code				F	CH2 mm	Material
	Dash	DN	inch			
SHFI-TR-00021	-4	6	1/4	1/4"-18	17	Steel
SHFI-TR-00017	-4	6	1/4	3/8"-18	19	Steel
SHFI-TR-00023	-4	6	1/4	3/8"-18	19	AISI 316L

### AGR

Fitting corresponding to stand pipe DIN 3852 with pipe thread  
G-form A mating with thread ports DIN 3852 and narrow seal



Item Code				F inch	CH2 mm	Material
	Dash	DN	inch			
SHFI-TR-00018	-4	6	1/4	3/8	22	Steel

Further types and sizes available on request.

**TOP COAT**



**DN 6 to 10 – WP 700 bar**

// Typically employed in power tools

// Compatibility with other couplings in-use

**ARGUS PTK high pressure couplings** can be used for connecting and disconnecting hydraulic lines. Their robust construction and tested components make them ideally suited for high and intermittent pressure loads. During the coupling action, valves that release and/or block the flow are automatically activated. The PTK quick release coupling, formed by coupling plug and coupling socket, is coupled by a screwing action with the hand nut of the plug component.

**Materials**

Galvanised steel HNBR O-rings (other materials optional). TOP COAT Cr-III zinc plating with additional trivalent passivation for outstanding surface protection.

**Suitable** for liquid lines with mineral oil-based hydraulic fluids to DIN 51524 T1+T2.

**Temperature range:** from -30 °C to +125 °C.

Additionally to the connection threads shown in the following tables, further types and sizes are available on request. Specific instructions for installation, use and maintenance are separately provided.

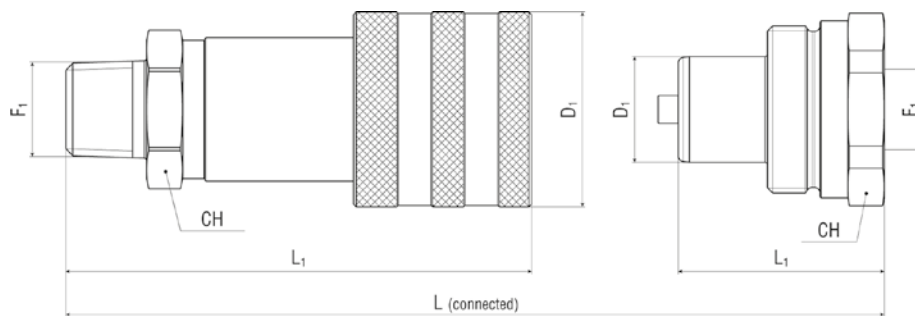

**SCREW COUPLING - POPPET PTK**

Female coupling - Male thread

Item Code				WP Conn.	BP Disconn.	Thread 1	F1	D1	CH	L1	L
	Dash	mm	inch	MPa	MPa			mm	mm	mm	mm
1233547	04	6,0	1/4"	70,0	280,0	NPTF	1/4-18	28,5	22,0	59,6	74,00
1233548	06	10,0	3/8"	70,0	280,0	NPTF	3/8-18	35,0	25,0	72,5	83,00

NPTF connection according to ANSI B1-20.3

**SCREW COUPLING - POPPET PTK**

Male coupling - Female thread

Item Code				WP Conn.	BP Disconn.	Thread 1	F1	D1	CH	L1	L
	Dash	mm	inch	MPa	MPa			mm	mm	mm	mm
1233545	04	6,0	1/4"	70,0	280,0	NPTF	1/4-18	15,8	19,0	32,5	74,00
1233546	06	10,0	3/8"	70,0	280,0	NPTF	3/8-18	19,0	32,0	35,0	83,00

NPTF connection according to ANSI B1-20.3